

# F64 NW Vacuum Fittings

## QF to QF Reducers, Aluminum

Part No.	A	B	NW Flange Size	Price ea.
QF25x16ACR	.62"	1.57"	25 to 16	
QF40x16ACR	.62"	1.57"	40 to 16	
QF50x16ACR	.62"	1.57"	50 to 16	
QF40x25ACR	.87"	1.57"	40 to 25	
QF50x25ACR	.87"	1.57"	50 to 25	
QF50x40ACR	1.37"	1.57"	50 to 40	

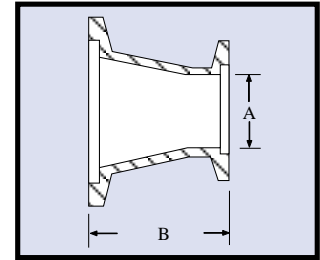

## 90° Stainless Elbow

90° elbow for mating NW vacuum flanges.

Part No.	A	NW Flange Size	Price ea.
QF16-075-E90	1.57"	16	
QF25-100-E90	1.97"	25	
QF40-150-E90	2.56"	40	
QF50-200-E90	3.17"	50	

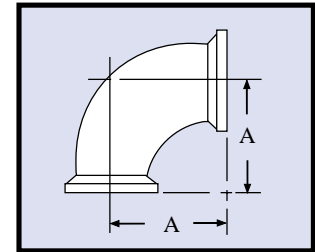

## QF Stainless 4-Way Crosses

Each 4-way cross has four NW flanges for up to 4 vacuum lines.

Part No.	A	NW Flange	Price ea.
QF16-075-X	1.57"	16	
QF25-100-X	1.97"	25	
QF40-150-X	2.56"	40	
QF50-200-X	2.76"	50	

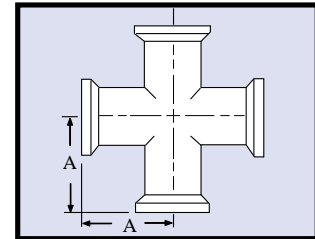

## QF Stainless Steel Tees

Three NW flanges permit the union of several pump lines.

Part No.	A	NW Flange Size	Price ea.
QF16-075-T	1.57"	16	
QF25-100-T	1.97"	25	
QF40-150-T	2.56"	40	
QF50-200-T	2.76"	50	

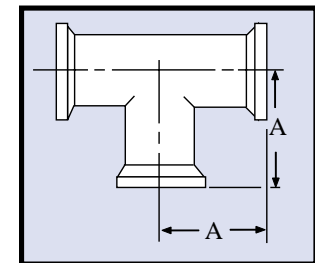

## QF to Flexible Stainless Hose

### 20" Length - Thin Wall

This thin walled metal hose with 2 NW flanges is for connecting pumps to vacuum systems

Part No.	A	I.D.	NW Flange Size	Price ea.
QF16-075-MH20	20"	5/8"	16	
QF25-100-MH20	20"	7/8"	25	
QF40-150-MH20	20"	1 3/8"	40	
QF50-200-MH20	20"	1 7/8"	50	

