

Perkin Elmer Q Mass Heater

The source heater for the Perkin Elmer Q Mass 900 and 910 instruments are available from S.I.S.™ Part number SC181900 is 3/16" diameter and is rated at 6 volts and 10 watts. The SC181910 is 1/4" diameter and is rated at 24 volts and 20 watts. Both heaters are 1.0" long.

Part No.	Description	Price ea.
SC181900	Q-Mass Heater, 3/16" dia., 6V, 10W	
SC181910	Q-Mass Heater, 1/4" dia., 24V, 20W	



SC181900

Perkin Elmer Q Mass Sensor

Part No.	Description	Price ea.
PRT-7	PRT for Perkin Elmer Q Mass	

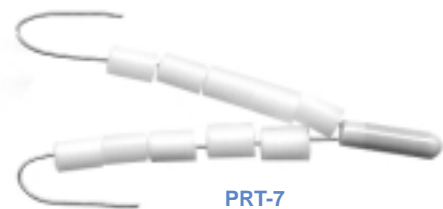

PRT-7

Perkin Elmer Q Mass Filament Assembly Repair

Part No.	Description	Price ea.
FILREPO	Repair of filament for the PE Q Mass 910	

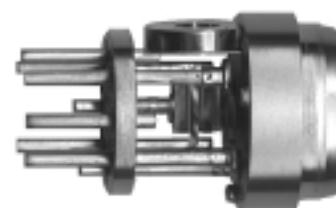

Q Mass

Perkin Elmer Q Mass Ceramic

Part No.	Description	Price ea.
PE100	Perkin Elmer Q Mass Ceramic	



Perkin Elmer Inner Source Cleaning

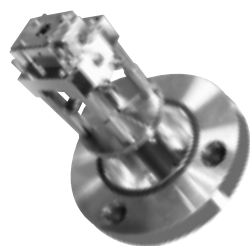

Parts Cleaned
Entire source block, lenses, insulators, filament and repeller assembly.

Parts Repaired
Filament

Not included in standard source cleaning price
Replacement of missing screws, filaments and cracked, broken or missing insulators.

Part No.	Description
REP-350	Source Cleaning of Perkin Elmer Inner Source

Perkin Elmer Outer Source Cleaning



Parts Cleaned
Entire source block, lenses, insulators.

Parts Replaced
All 4 ceramic rods are replaced with new ceramic rods

Not included in standard source cleaning price
Replacement of missing screws, copper spring contacts, other metal parts and cracked missing or broken insulators.

Part No.	Description
REP-349C	Source Cleaning of Perkin Elmer Outer Source (includes replacement of Ceramics)

For more detail on source cleaning see pg. A4

JEOL Ceramic Insulators

Part No.	JEOL #	Description	O.D.	I.D.	Length
JC1	620011351	Ceramic Insulator	0.281"	.203"	.216"
JC2	620011394	Ceramic Insulator	0.281"	.203"	.097"
JC3	620011396	Ceramic Insulator	0.276"	.203"	.375"
JC4	800132602	Ceramic Insulator	0.276"	.085"	.140"
JC5	801492106	Ceramic Insulator	0.197"	-	1.70"

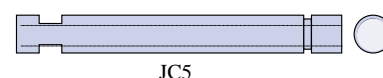

JC5

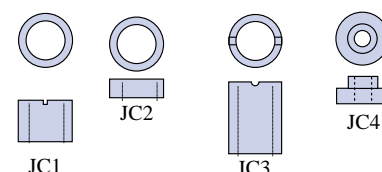

JC1

JC2

JC3

JC4